

A.P. GIANNINI MIDDLE SCHOOL GREEN INFRASTRUCTURE FINAL REPORT | JUNE 2025

COMMUNITY ENGAGEMENT & CONCEPT DESIGN



TABLE OF CONTENTS

1. Introduction
 - a. Scope of Work
 - b. Community Engagement Plan August - December
 - c. Community Engagement Plan January - May
2. Community Engagement Activities
 - a. Back to School Night
 - b. Community Meeting #1
 - c. Onsite Observations + Meeting w/ PE
 - d. Student Workshop
 - e. Community Meeting #2
 - f. Teacher and Staff Breakfast
 - g. Afterschool Music Event
 - h. Site Committee Meeting Series
 - i. PTSA Final Concept + Funding Notice
 - j. Web Survey
 - k. Existing Site + Key Insights Gathered
 - l. Identified Flooding
3. Concept Design
 - a. Massing Diagram
 - b. 100% Concept Plan
 - c. Physical Education Groups
 - d. Enlargement: Strengthened Community Zone
 - e. Enlargement: Re-imagined Entrance to the Yard
 - f. Enlargement: Lower Yard Improvements
 - g. Enlargement: Exterior Rain Gardens
 - h. ADA Considerations
4. Stormwater Management
5. Conclusions + Next Steps
6. Appendices:
 - a. Meeting + Engagement Complete Reports
 - b. APG Engagement Plan



1a INTRODUCTION | Scope of Work

The A.P. Giannini Middle School Green Infrastructure Project is a collaboration between the San Francisco Public Utilities Commission (SFPUC), San Francisco Unified School District (SFUSD) to develop a performance based green infrastructure (GI) concept to manage stormwater and support community and educational programming. This document summarizes the community engagement process and resulting concept design. Community engagement is essential for building trust, promoting transparency, and ensuring that designs, policies, and programs meet the school community's needs. Community engagement aims to foster a collaborative relationship between the project team and the community it serves. It allows the project team to better understand the needs, concerns, and priorities, and creates opportunities for the school community to provide input and feedback on the project redesign.

Community engagement in this process included community meetings, site observations, workshops, as well as the use of online survey tools. Engagement can be done on a spectrum that ranges from outreach to consultation, to involvement, to collaboration, and empowerment. The A.P. Giannini Green Infrastructure project has used each of these levels. The community engagement process for this Project began in August 2024 and will conclude in May 2025 with a presentation of the final conceptual landscape design.

In addition to this document, the design team has created a Miro Board to capture feedback from community participants including presentation boards, comments received, meeting notes, etc. from each engagement event. Engagement reports and the A.P. Giannini Engagement Plan Document will be included in the Appendix.

1b INTRODUCTION | Community Engagement Timeline August - December 2024

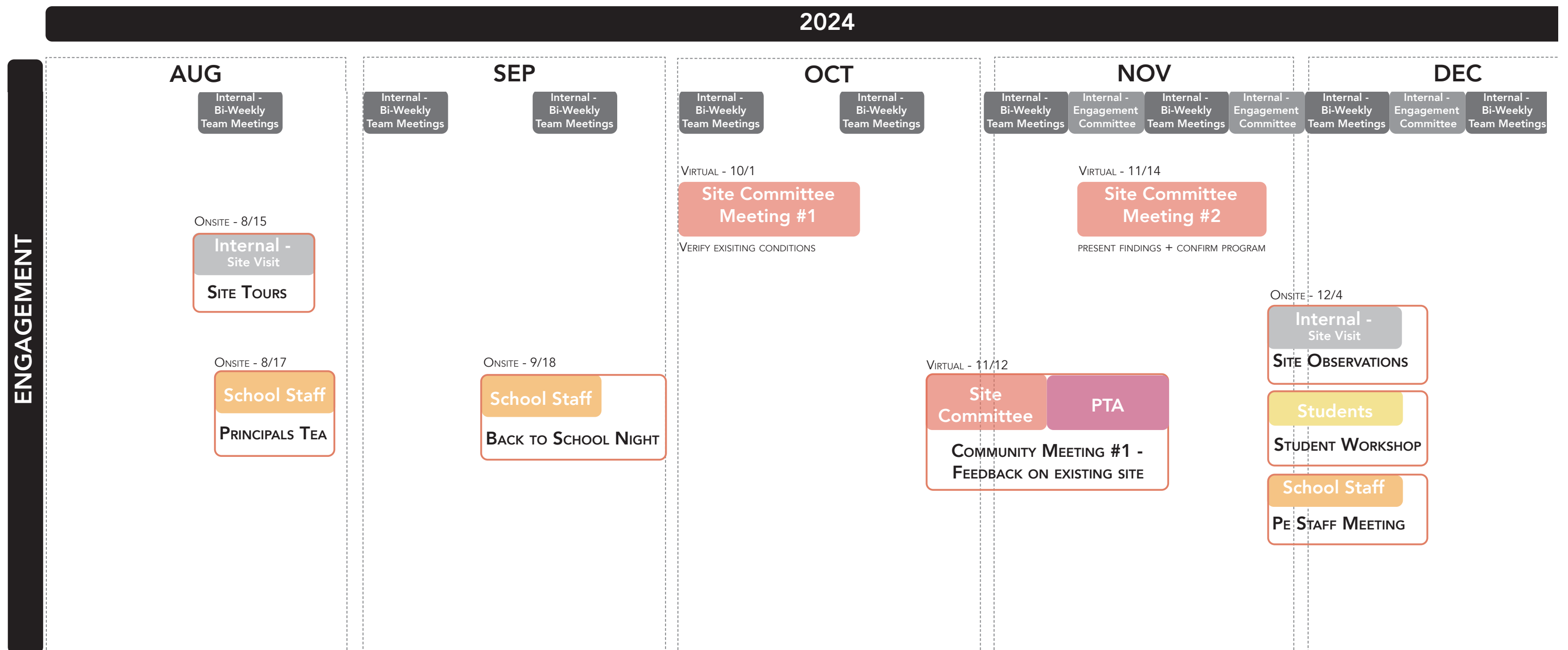
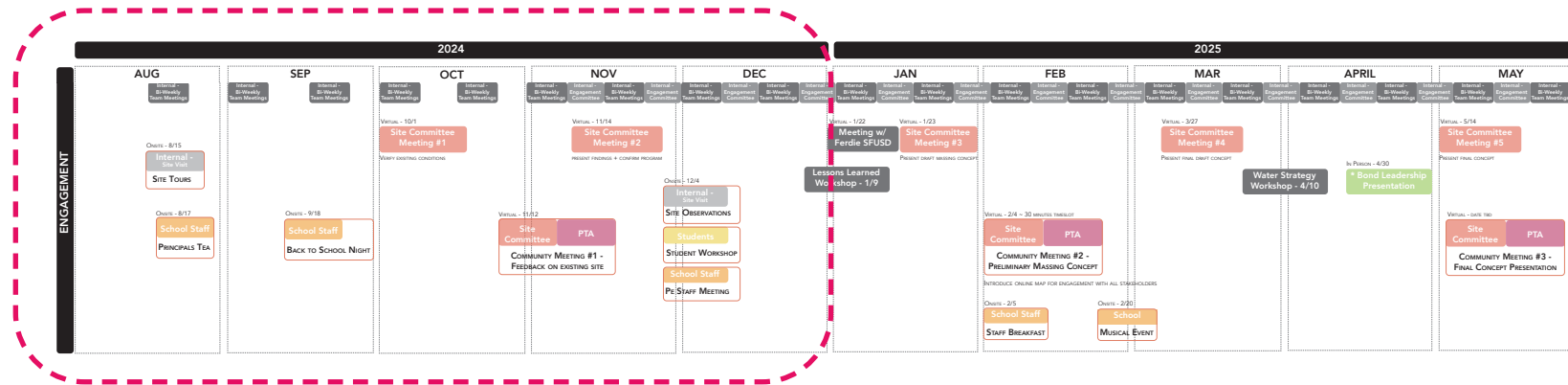

1c

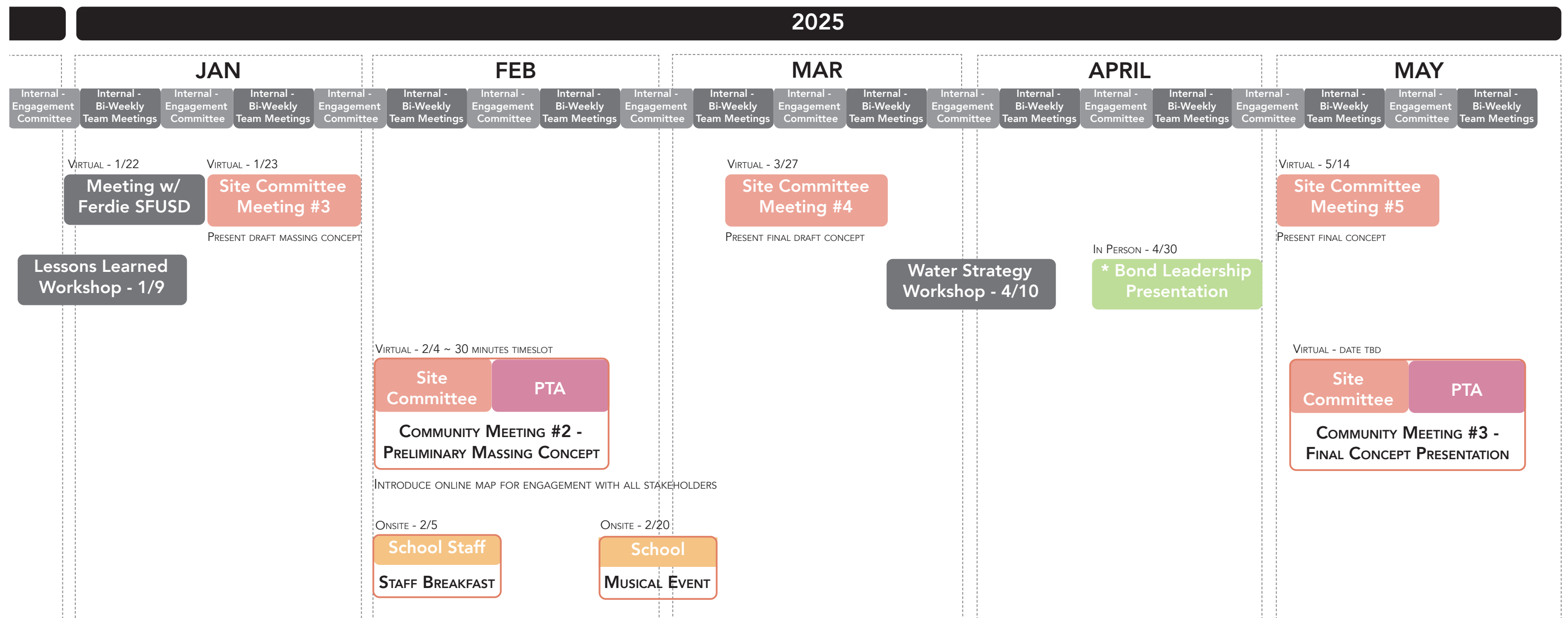
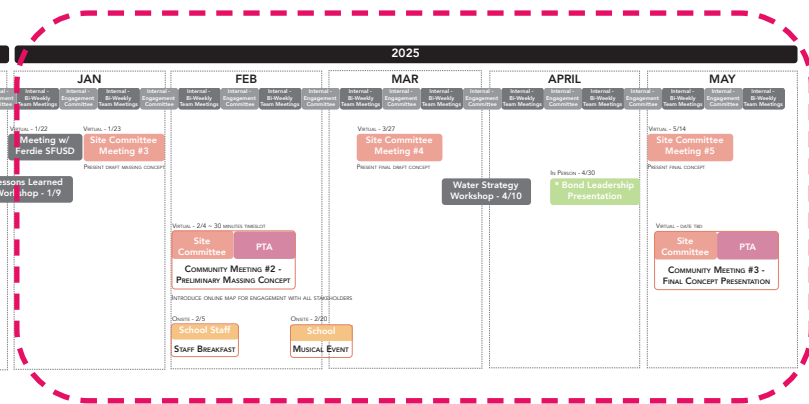

2a COMMUNITY ENGAGEMENTS | Back to School Night

In September, the school hosted an open house for parents. During this event, SF Public Utilities Commission, BASE Landscape Architecture, and Brown & Caldwell staff shared project information with attendees. In addition to general SFPUC project boards, BASE created precedent boards with concept images, descriptive words, and invited participants to provide feedback and vote on their favorites.

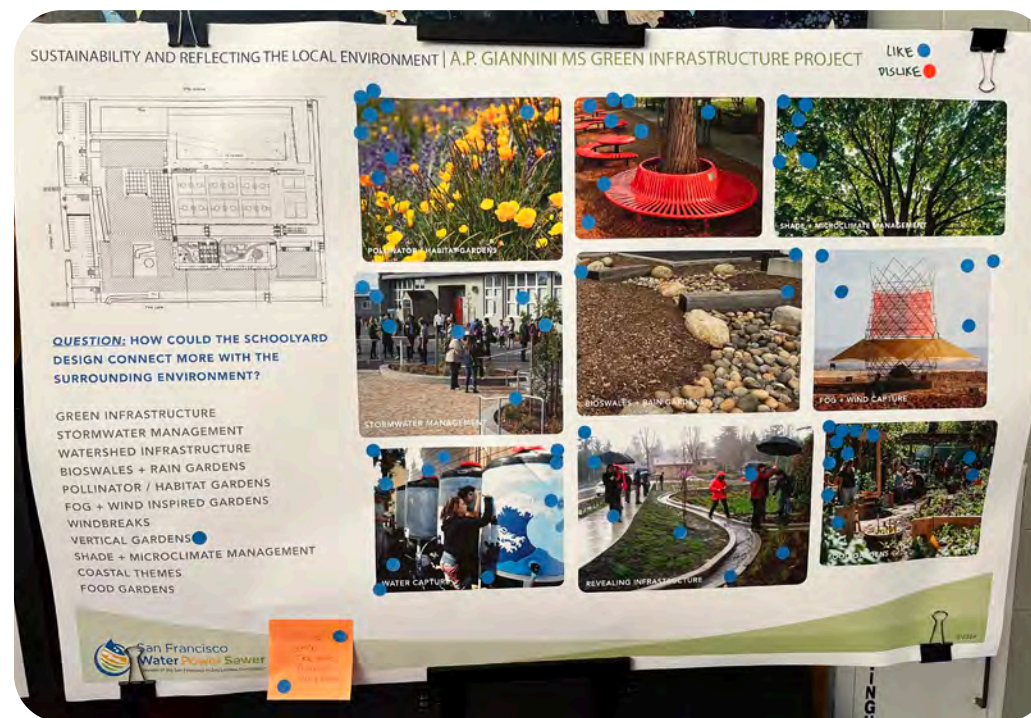

[LINK TO FULL REPORT](#)

Date: 9/24/2024

Time: 5:30-8:00pm

In Person

OBJECTIVES:

- Share project information with parents and school staff
- Identify site issues and/or constraints
- Solicit big picture schoolyard design and programming preferences from parents and teachers through an interactive and informal process
- Educate on green infrastructure and how it might be applied to the school

MEANS OF ENGAGEMENT:

- Participants reviewed project boards with concept images and guided questions
- Participants provided feedback through written comments on post it notes and sticky dot voting on images and activity photos
- Conversations with visitors were captured with notes from the project team

KEY ENGAGEMENT NOTES:

- Drainage issues in the yard, "Lake APG"
- Desire for more permeable surface, less concrete
- Need for more shade, trees, and planting
- Lack of seating, hope for more clustered and creative edging
- Enthusiasm for diverse play elements, most notably obstacle course and outdoor games
- Need for free exploration during open play
- Support for creative water capture

2b COMMUNITY ENGAGEMENTS | Community Meeting #1

Community meetings were held in coordination with the PTA, scheduled during existing PTA meeting times. BASE Landscape Architecture presented on schoolyard existing conditions and gathered input on priorities for the reinventing the schoolyard. An interactive Miro board featuring precedent images was used to solicit feedback and encourage input on the different ideas. BASE developed invitation fliers and letters formatted on the SFPUC letterhead. SFPUC communicated to PTA via email.

SCHOOLYARD EXISTING CONDITIONS | A.P. GIANNINI MS GREEN INFRASTRUCTURE PROJECT

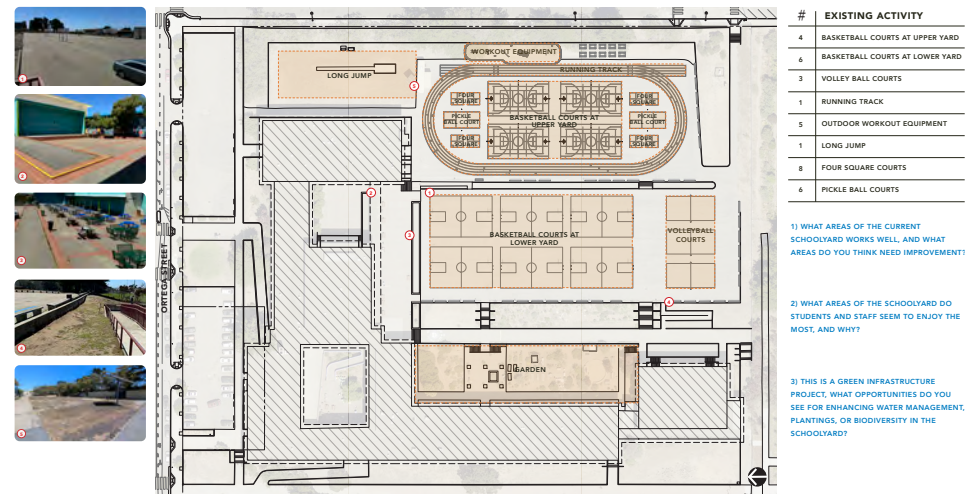

WHAT WE'VE HEARD | A.P. GIANNINI MS GREEN INFRASTRUCTURE PROJECT

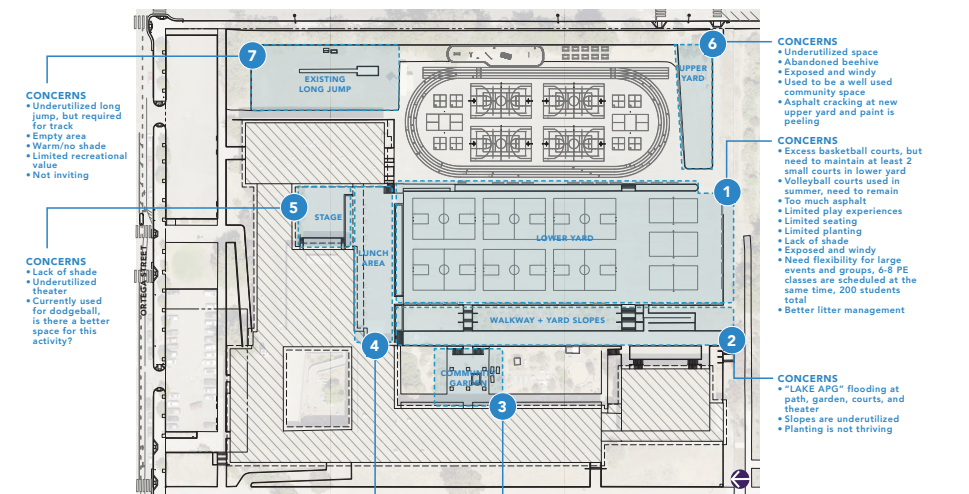

OPPORTUNITY AREAS | A.P. GIANNINI MS GREEN INFRASTRUCTURE PROJECT

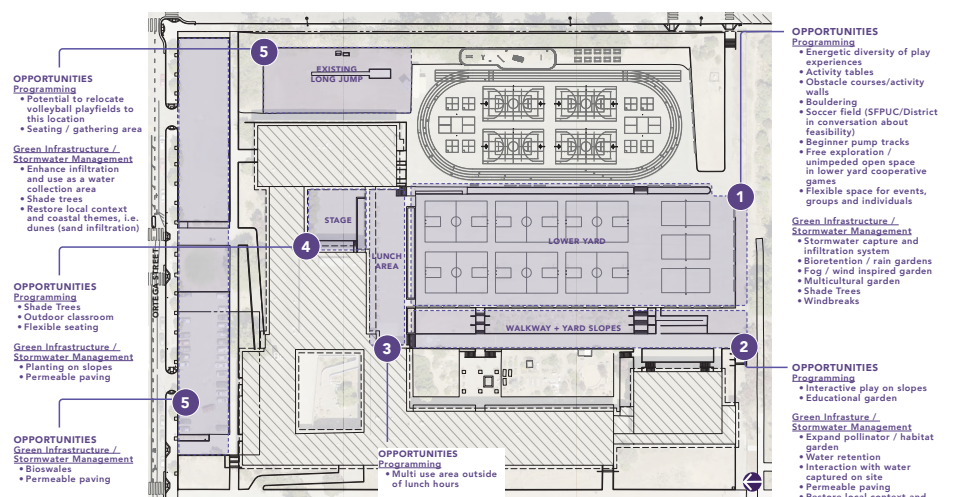

OPPORTUNITY AREAS | A.P. GIANNINI MS GREEN INFRASTRUCTURE PROJECT



MIRO BOARD
LIVE COMMENTING
DURING MEETING

LINK TO FULL REPORT

Date of Event: 11/12/2024

Time: 6:30-8:00pm

OBJECTIVES:

- Share project information with community
- Clarify existing site issues and constraints
- Solicit big-picture schoolyard design and programming preferences

MEANS OF ENGAGEMENT:

- The BASE team facilitated presentation in an online format meeting as requested for flexibility and to capture more participants
- Multiple design options were offered
- Interactive Miro board with precedent images to gain input on the different ideas
- BASE also provided space for comments and suggestions via live chat and discussion

KEY ENGAGEMENT NOTES:

- Excitement for how green infrastructure can be integrated into schoolyards (ie raingardens, permeable paving)
- Site is dominated by hardscape
- Limited diversity of play options, too many basketball courts
- Not enough shade or flexible spaces for small or large groups
- Lunch area hot and not very welcoming
- Need for special education inclusive areas, soft surfacing and quiet zones
- Track is slippery when wet
- West side concerns, community wants to bring back previously removed trees

2c COMMUNITY ENGAGEMENTS | Onsite Observations + Meeting with PE

In December, staff from BASE Landscape Architecture, SF Public Utilities Commission, and Brown & Caldwell visited the school during lunch and physical education hours to observe how the schoolyard site was being used during those times. Following the observations, the team met with all PE instructors to discuss their spatial needs for teaching on the site. These teachers shared their desired use for the space along with constraints and key considerations.



[LINK TO FULL REPORT](#)

Date of Meeting: 12/4

Time: 2:30-3:15

**Observed PE during 5th and 6th periods*

OBJECTIVES:

- Observe the yard at its highest use time
- Clarify site use issues and constraints specific to PE
- Solicit big-picture schoolyard design and programming preferences from PE teachers

MEANS OF ENGAGEMENT:

- BASE, SFPUC, and BC staff attended the school during lunch and physical education hours to observe how the schoolyard site was used during those times
- After the observations, the team met in person with all PE teachers to talk about their spatial needs for teaching physical education on the site

KEY ENGAGEMENT NOTES:

- Approx. 1,000 students use the yard during lunch, no staggered schedule
- Lots of active and passive activities observed (active: basketball, volleyball, football, soccer) and (passive: (sitting on slopes, table games, casual walking)
- Shade is extremely limited throughout the yard
- Uneven slippery surfaces
- Active play impedes into eating areas, potential conflict
- PE classes are divided into 6 groups of 28 students (each group needs approx. two full basketball courts)
- Open flexible space preferred, avoid barriers
- Some activities require hardscape: Basketball, volleyball, ripsticks etc
- Some activities require soft surfacing: Football, soccer, lacrosse
- Need for more seating with shade for PE breaks

2d COMMUNITY ENGAGEMENTS | Student Workshop

BASE Landscape Architecture, SF Public Utilities Commission, and Brown & Caldwell staff observed the Beacon after-school program. BASE presented to the students on design concepts and then facilitated a design charrette. Using scaled site plans and a distributed a kit of parts, BASE guided students in envisioning and designing their ideal schoolyard.

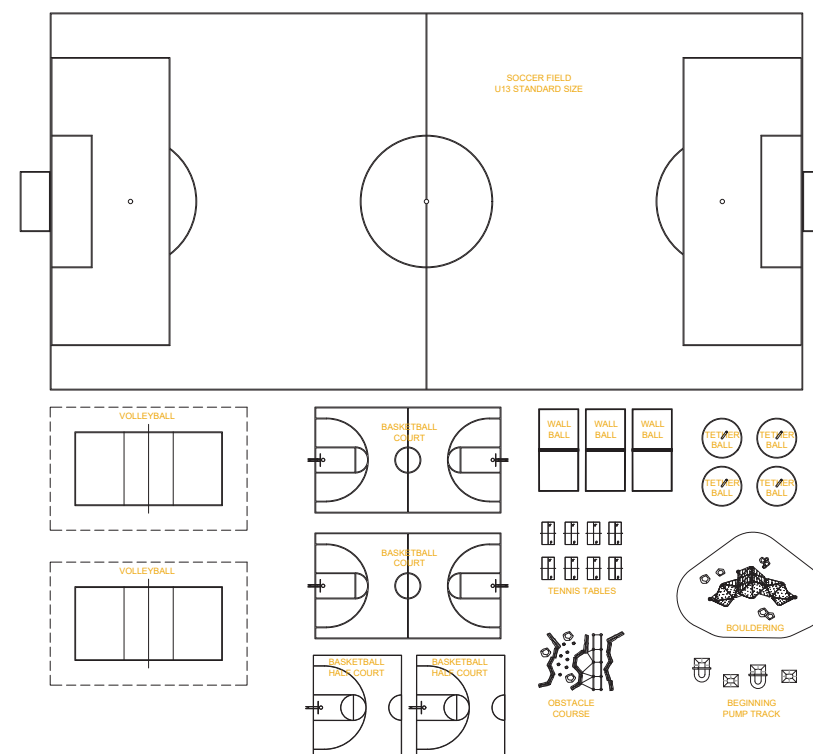
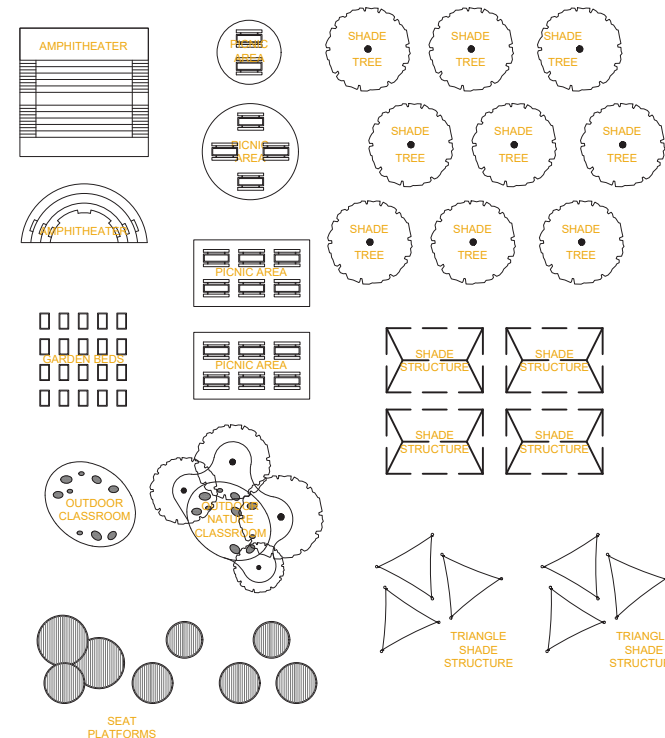

[LINK TO FULL REPORT](#)

Date of Meeting: 12/4

Time: 3:30 – 5:00 (after school 90 minutes)

OBJECTIVES:

- Educate and expose students to the design process
- Clarify existing site issues and constraints the students have experienced in the schoolyard
- Solicit big-picture schoolyard design and programming preferences from student perspective

MEANS OF ENGAGEMENT:

- BASE presented and facilitated an in person student design charrette
- The team presented scaled site plans and distributed a "kit of parts" that allowed students to design the schoolyard of their dreams
- Feedback was recorded and incorporating in the design

KEY ENGAGEMENT NOTES:

- Lower yard has rough, slippery and uneven surfacing which causes falls and injuries
- More shade needed, especially in lunch area
- Beehive area is unused and feels unsafe
- More greenspace requested throughout the yard
- Too many basketball courts, need for more options for play
- Equipment closet is poorly located and causes congestion at lunch time
- Students enter eastern side of school but early morning students enter through main office ramp

In February, the BASE team presented the preliminary schoolyard concept design ideas to the PTA and Staff. The team requested input and first reactions to the design. Input from the discussion was synthesized, documented, and informed the refinement of the final concept design.

SCHOPLYARD MASSING CONCEPT | A.P. GIANNINI MS GREEN INFRASTRUCTURE PROJECT

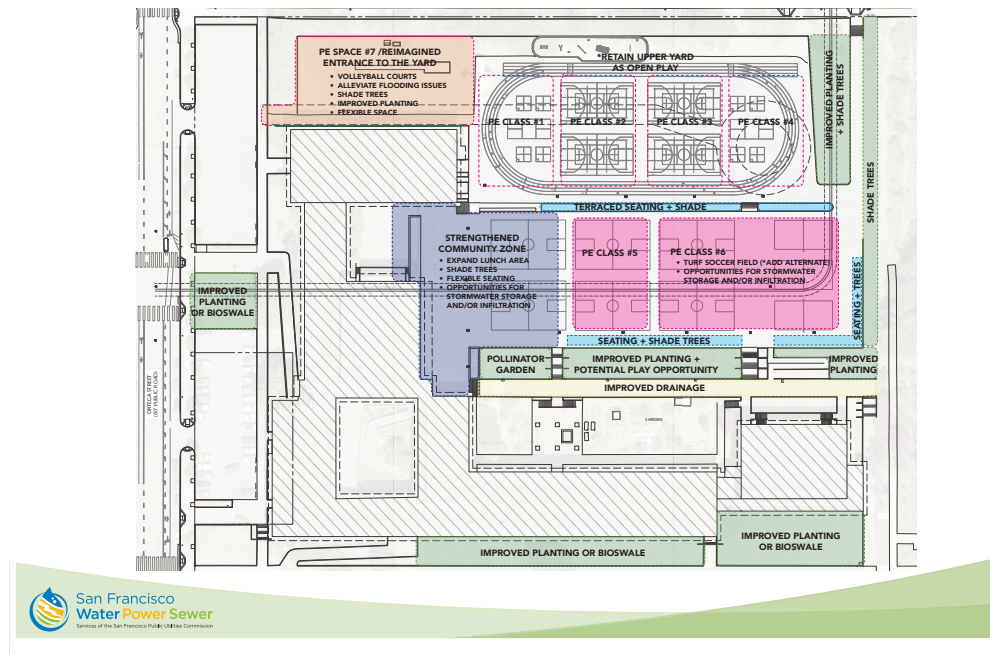

SCHOOLYARD MASSING CONCEPT | A.P. GIANNINI MS GREEN INFRASTRUCTURE PROJECT

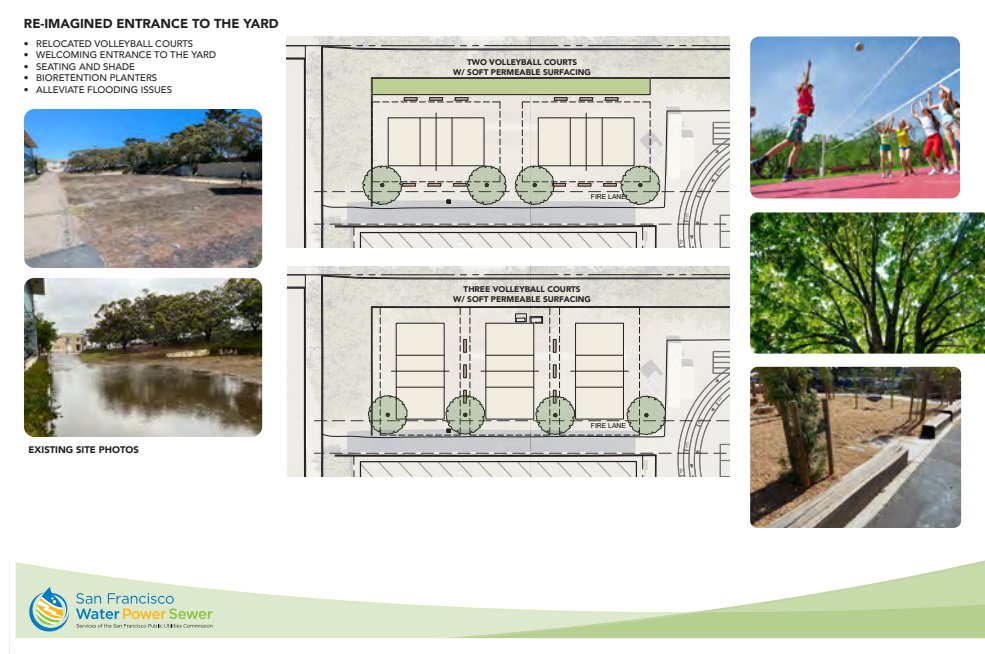

SCHOOLYARD MASSING CONCEPT | A.P. GIANNINI MS GREEN INFRASTRUCTURE PROJECT



SCHOOLYARD MASSING CONCEPT | A.P. GIANNINI MS GREEN INFRASTRUCTURE PROJECT



LINK TO FULL REPORT

Date of Meeting: 2/4
Time: 7:00 – 7:30pm

OBJECTIVES:

- Present massing diagrams and preliminary concept ideas
- Present multiple design options for response
- Establish common priorities to inform the development of the conceptual design
- Provide meaningful opportunity for stakeholders to craft the concept plan

MEANS OF ENGAGEMENT:

- The BASE team facilitated presentation in an online format meeting as requested for flexibility and to capture more participants
- BASE powerpoint presentation of preliminary concept design
- Requested input on the design via live chat and discussion

KEY ENGAGEMENT NOTES:

- Need for seating around all outdoor activities
- Concerned about containment of soccer balls and the need to install nets around soccer field
- Flooding identified in upper parking lot, potential for bioswales in the design and stormwater management plan
- Overall excitement for the strengthened community zone and expanded shaded areas for lunch
- Preference of soccer field farther from lunch area
- Concern for previously planted slopes by the APG garden club (students + parent volunteers)

2f COMMUNITY ENGAGEMENTS | Teacher + Staff Breakfast

BASE presented the preliminary concept design for the schoolyard to teachers during their PTA hosted staff breakfast. The session was intended to gather additional input, validate previous assumptions, and inform final refinements to the design. Input was gathered through discussion and written on post its.

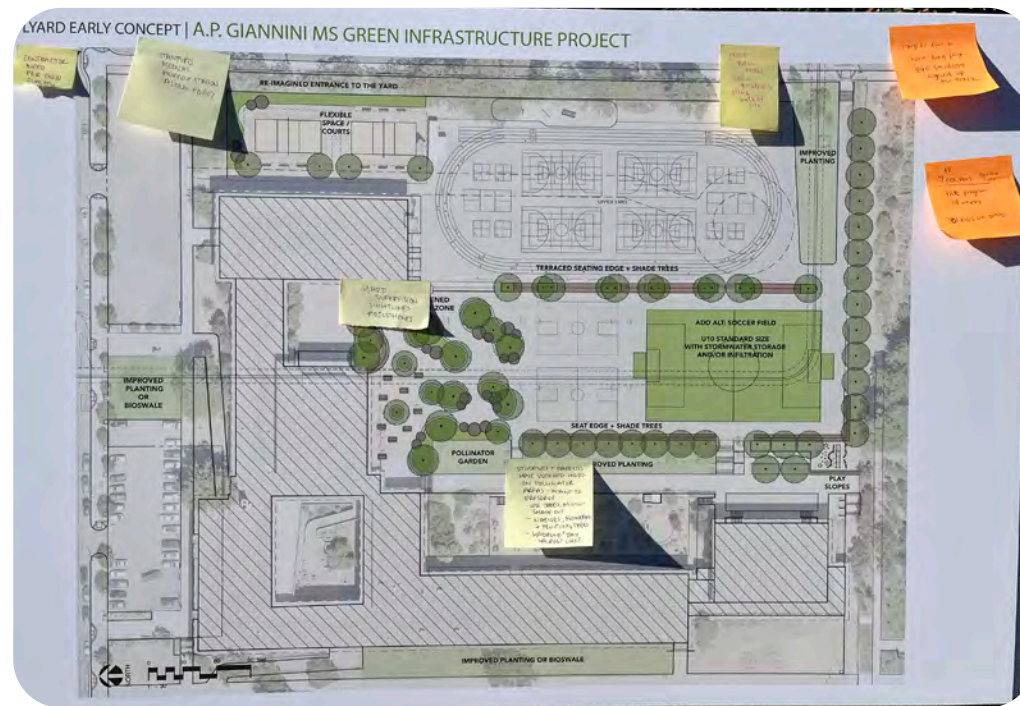

[LINK TO FULL REPORT](#)

Date of Meeting: 2/5

Time: 8:30 – 9:30am

OBJECTIVES:

- Present preliminary concept site plan to teachers and staff
- Establish common priorities to inform development of the concept design
- Provide a meaningful opportunity for stakeholders to provide input on the concept plan

MEANS OF ENGAGEMENT:

- BASE prepared and printed large scale concept boards to present during the regularly scheduled PTA Staff Breakfast
- Encouraged written comments on post it notes and placed on the boards
- Direct conversation, engagement, and notes

KEY ENGAGEMENT NOTES:

- Overall excitement + support for concept ideas
- Garden coordinator concern for impact on APG garden club planted slopes, would like to see natives in the future planting palette
- Need to keep the long jump in the design
- Comments supporting the play slopes and a creative ways to circulate the site
- Concern for quality of contractors selected
- Strong enthusiasm for proposed terraced seating between the upper and lower yard
- PE would like to bring back the bike program, which is approx. 14 weeks long + 30 students at a time

2g COMMUNITY ENGAGEMENTS | Afterschool Music Event

At the school's evening performance event in February, the team set up a table outside the amphitheater to present the initial concept design and receive comments/input from event attendees. Feedback was collected in person via Post-it notes placed directly on the boards, or later online via the site map tool. A QR code for the site map was provided at the event and remained available via the website for those who might not have been present at that event but still wanted to participate, be informed, and provide feedback.

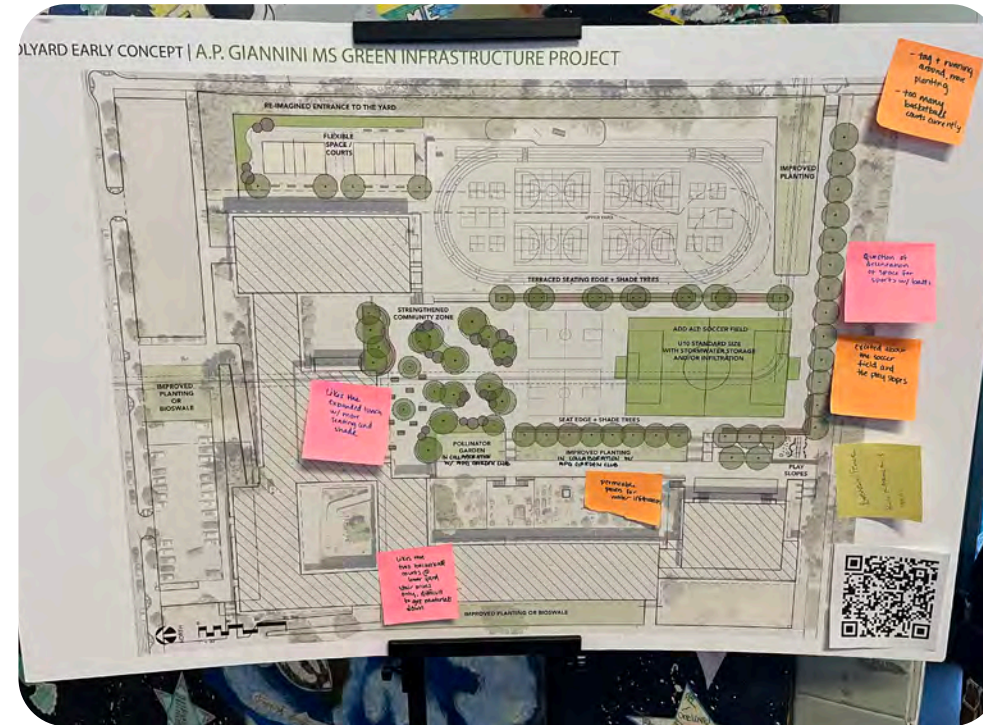

LINK TO FULL REPORT

Date of Meeting: 2/20

Time: 4:15 – 6:00pm

OBJECTIVES:

- Present preliminary concept plan in person to parents and students attending the afterschool event
- Establish common priorities to inform the development of the conceptual design
- Provide a meaningful opportunity for families to craft the concept plan

MEANS OF ENGAGEMENT:

- Team facilitated a table outside the theater to present the initial concept design
- Invited feedback either in person via Post-it notes placed directly on the boards, or later online via the site map tool.
- A QR code for the site map provided on boards for those who would like participate at another time

KEY ENGAGEMENT NOTES:

- Strong support for removing existing asphalt planters to expand lunch area and add shade
- Preferred images that reflect natural materials for seating and terracing
- APG Garden Club rep commented that they would like to be included when plant selection begins in the design process
- Excitement for the soccer/play field
- Positive response to preserving flexible space in the yard
- Question about delineating space for ball sports

2h COMMUNITY ENGAGEMENTS | Site Committee Meetings

BASE worked with SFPUC to select the key community stakeholders to represent the site committee at meetings. The Site Committee is comprised of representatives from SFUSD and PTA, the school principal, and certain key teachers, such as PE, science, and the garden teacher. Site Committee members are stakeholders that have been identified as representatives of different important community groups.

Introductions

SFPUC Project Team		AP Giannini Site Committee	
Mary Tienken	SFPUC Project Manager	Tai Schoeman	Principal
Jimmy Fu	SFPUC Project Engineer	Heidi Smoot	Vice Principal
Will Logsdon	SFPUC WVE/OR	Jason Blum	Teacher
Hans Tremmel	B&C Project Manager	Angie Sibelman	Teacher
Rosey Jencks	B&C Water Practice Lead	Ruben	Parent
Patricia Algara	BASE Project Manager	Emma Silvius	Parent
Hannah Greendorfer	BASE Landscape	Beth Guy	Beacon Director

SEWER SYSTEM IMPROVEMENT PROGRAM | Grey, Green, Clean.

Programming

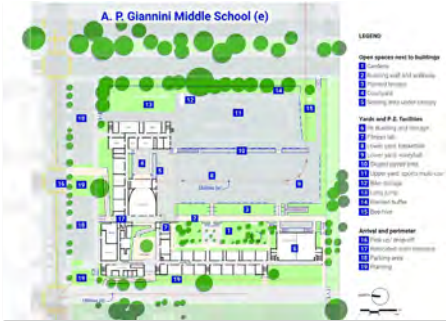

SEWER SYSTEM IMPROVEMENT PROGRAM | Grey, Green, Clean.

Lafayette Elementary School



5

Existing Conditions - Programming

1. Current Programming in the Yard
 - During School
 - Before/After School
 - Weekend
2. Use of Upper/Middle/Lower Yards



SEWER SYSTEM IMPROVEMENT PROGRAM | Grey, Green, Clean.

11

Dates of 5 Meetings: 10/1, 11/14, 1/23, 2/19, 5/14
Time: Varied per date

OBJECTIVES:

- Review and develop recommendations for schoolyard use
- Provide valuable insight and feedback regarding the schoolyard's conceptual design.
- Share issues, concerns, or priorities related to schoolyard designs prior to community engagements.
- Apply their specialized expertise and provide feedback on uses and appropriate redesign of the schoolyard that will accommodate stormwater infiltration while maintaining the best use of the school property.
- Review the draft concept plan. BASE will develop fliers and invitation letters formatted on SFPUC letterhead. The SFPUC team will send these materials to the Site Committee group via email. Site Committee meetings will be co-facilitated by BASE and SFPUC staff; the SFPUC staff will schedule meetings and will a Zoom link for virtual meetings. BASE will prepare presentation materials.
- Roles and responsibilities:
 - SFPUC staff communicated with school principal to identify Site Committee members and meeting formats
 - SFPUC staff to coordinate stakeholder meeting schedules
 - BASE + SFPUC staff drafted meeting objectives and agendas
 - BASE prepared and facilitated or co-facilitated meetings
 - BASE assisted meeting logistics related to the virtual platform set up
 - BASE recorded notes and submitted reports for each engagement

MEANS OF ENGAGEMENT:

- Five Site Committee meetings are planned. It is anticipated that these meetings will be facilitated (using the zoom hand raising, chat, and whiteboard functions) through a virtual meeting platform such as Zoom.

SCHOOLYARD MASSING CONCEPT | A.P. GIANNINI MS GREEN INFRASTRUCTURE PROJECT

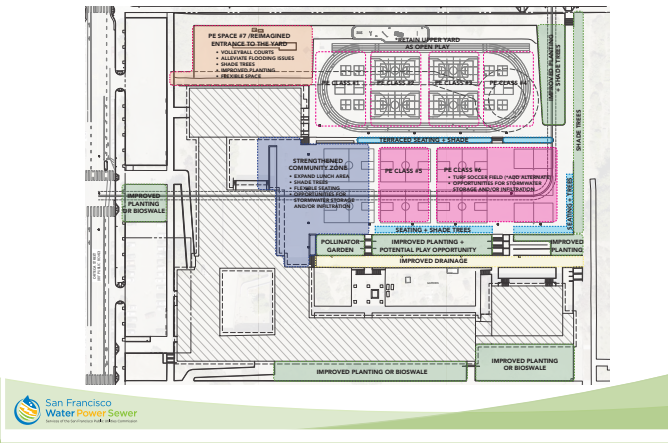

SCHOOLYARD MASSING CONCEPT | A.P. GIANNINI MS GREEN INFRASTRUCTURE PROJECT

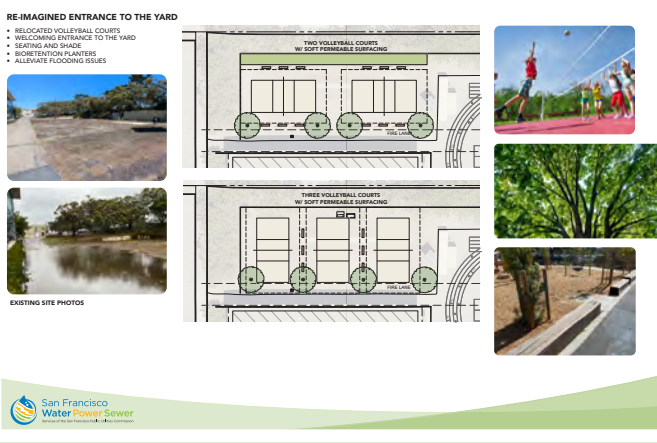

2i COMMUNITY ENGAGEMENTS | PTSA Final Concept + Funding Notice

As a part of the ongoing collaboration with the community, the design team shared a final update on the A.P. Giannini Schoolyard project. This communication outlines key design updates, funding priorities, and next steps as the project moves into the design phases.

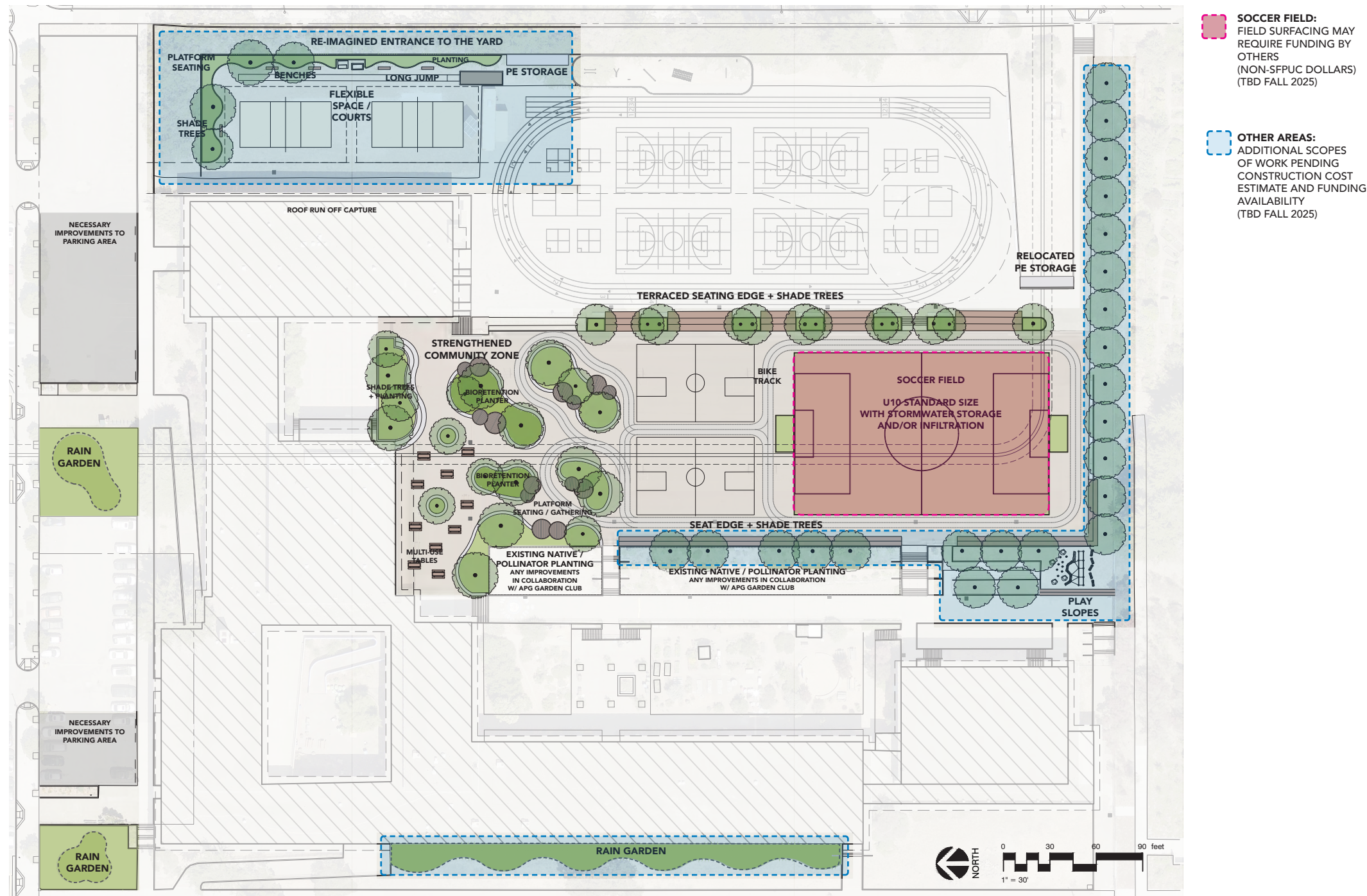

Date of Notice: 5/23/2015

OBJECTIVES:

- Share concept update and funding priorities with the PTSA community

DISTRIBUTED CHANNELS:

- PTSA BiWeekly Meetings
- PTSA Social Media
- Principal and Vice Principal

NOTICE:

Dear APG PTSA Community,

As we near the end of the school year, we would like to share an update on the SFUSD and SFPUC green schoolyard project at AP Giannini Middle School. The APG schoolyard will be redesigned with new landscape features that capture stormwater, add green space, and enhance student experience of the schoolyard. The project has now completed the conceptual design phase. Thank you to those that have provided feedback to the project team on the schoolyard design. We would like to share the final concept design (attached and provided below), and provide the following next steps on this project:

SFPUC and SFUSD will begin detailed design and engineering in Summer 2025 and into 2026. This will include detailed cost estimating. The inclusion of certain project elements, including the proposed soccer field, seating, and shade trees are pending construction cost estimate and funding availability.

- The project team will report back to the school community with project updates in Fall 2025.
- The project is targeting a construction start date of Summer 2027.

For additional information on this project, including community engagement completed so far please visit the website at www.sfpuc.gov/apgiannini.

FLYER:

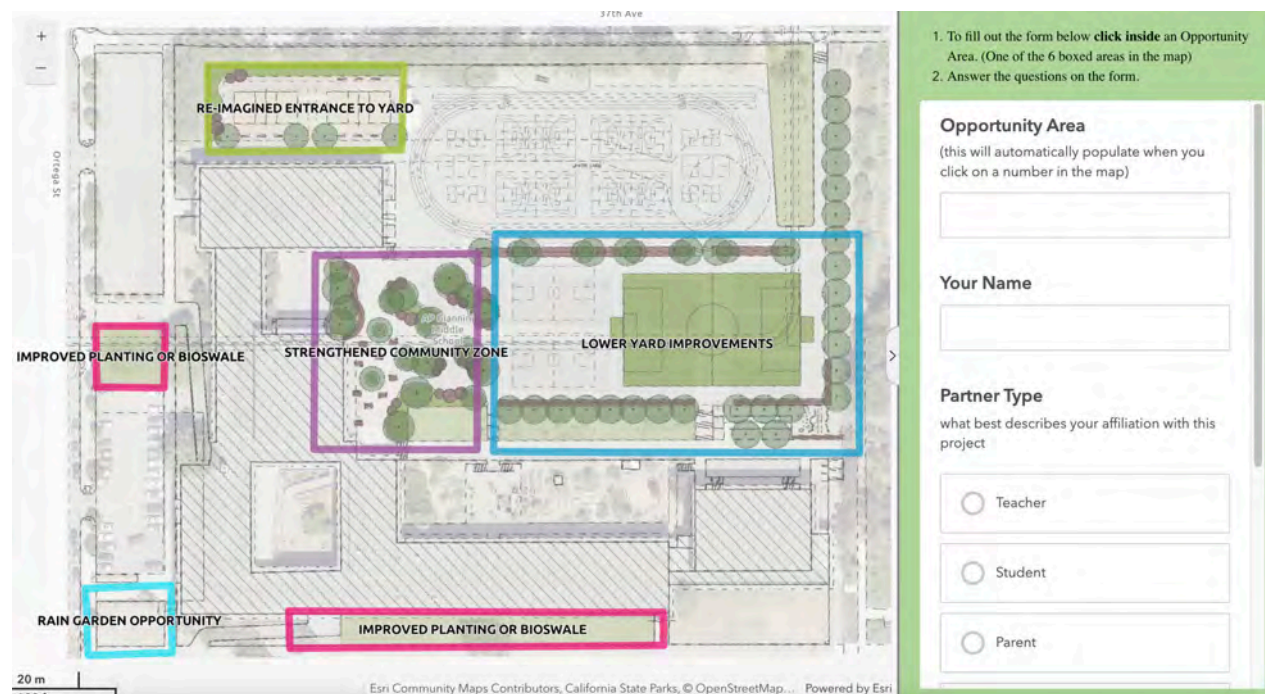
**LINK** TO WEB SURVEY QUESTIONS AND COMPILED RESPONSES

BASE Landscape Architecture and Brown and Caldwell collaborated to create a web application to share project concepts for stakeholder feedback. The web application is via ESRI ArcGIS Online solution that compiled the data received. Included:

- A landing page with a project overview
- A form-based tool for users to enter input based on selection of a feature or location of interest

OBJECTIVES:

- To provide an online engagement tool where the extended school community can participate and provide feedback about the concept design

DISTRIBUTED CHANNELS:

- Emailed to families via The weekly APG parent newsletter
- Sent in Beacon Newsletter
- PTSA BiWeekly Meetings
- PTSA Social Media
- Flyer posted in school
- Available during onsite engagements

RESPONSES:

- Received 35 total responses
- 30% Parents, 50% Teachers, 10% Students, and 10% Other

KEY ENGAGEMENT NOTES:

- Overall positive response to the initial concept plan ideas
- Likes that the design represents student activities other than sports, wants ART
- Would like future planting palette to include natives and colorful plants and a strong desire to leave all garden club work as is
- Concern about trash in the current yard, need for more bins
- Small spaces for gathering is supported and highly desired
- Strong support for the soccer field and turf as a multi use space, slight concern for cleaning surface and fencing being played on
- Important to keep the long jump for track and PE
- Full support of tiered seating, especially around sports areas
- Climbing and play slopes are slightly debated, worried about safety, recommendations for slides
- Shade across the community zone is a must
- Hills and slopes for climbing and hide a seek suggested by student

2k COMMUNITY ENGAGEMENTS | Existing Site + Key Insights Gathered from all Engagements

General Yard Observations

- The yard is heavily used, with approximately 1,100 students during lunch
- No shade available
- Limited seating options, most students sit on the ground or concrete slopes
- Lunch tables are at capacity during lunch
- The yard is loud, with no defined quiet areas
- Limited green space
- Overcrowding and dominance of older and male students leave younger students with fewer options

Safety Hazards:

- Slippery surfaces in the lower and upper yard
- Uneven surfaces and loose gravel in the lower yard cause frequent falls + injuries
- Volleyball courts are uneven and hazardous

Programming:

- Need to represent student activities other than sports
- Too many basketball courts, no diversity of play
- PE needs 6 separate areas for class, each approx. the size of 2 basketball courts
- PE activities that require hardscape: Bikes, Ripsticks, Basketball, Pickleball, Tennis, Handball, Floor Hockey, Four Square, Track
- There are activities that can happen in flexible spaces: Dance, Yoga, Workout Circuits, Park Games
- PE staff prefer open, flexible spaces without barriers to accommodate various activities
- Interest in softer surfaces for volleyball, football, soccer, and lacrosse
- Interest in bringing in cross training and the bike program back, but conflicts with other activities
- Creative elements like play slopes and obstacles have been suggested and highly desired
- APG Garden Club would like to be included in future planting efforts, ie plant selection

Flooding Issues

- Pooling water along the walkway ("Lake APG"), the lower yard, lunch area, and near the long jump

Accessibility

- A single, long, and steep ramp between levels restricts accessibility
- The current yard equipment storage location leads to crowding at lunch

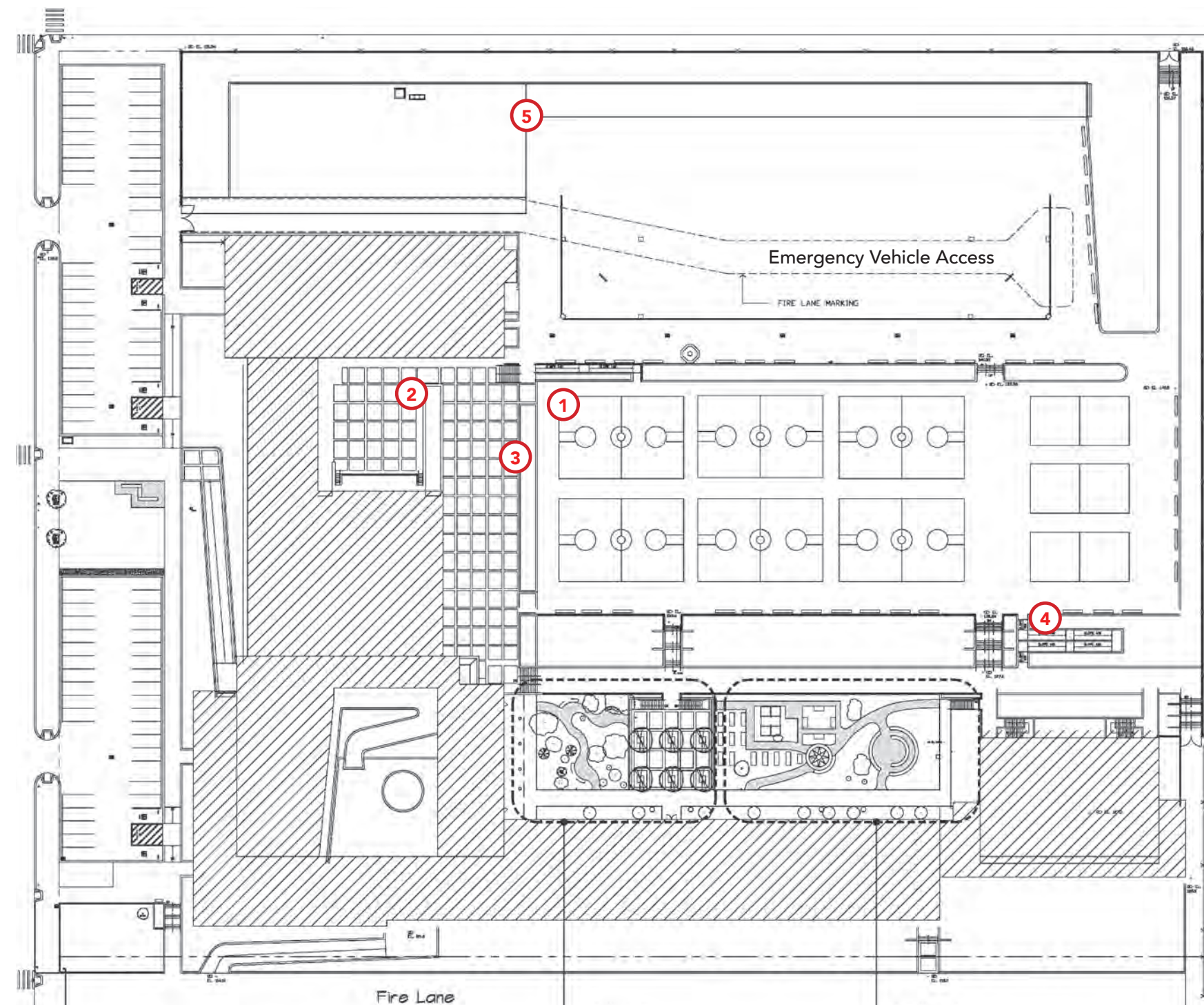

21 COMMUNITY ENGAGEMENTS | Identified Local Flooding

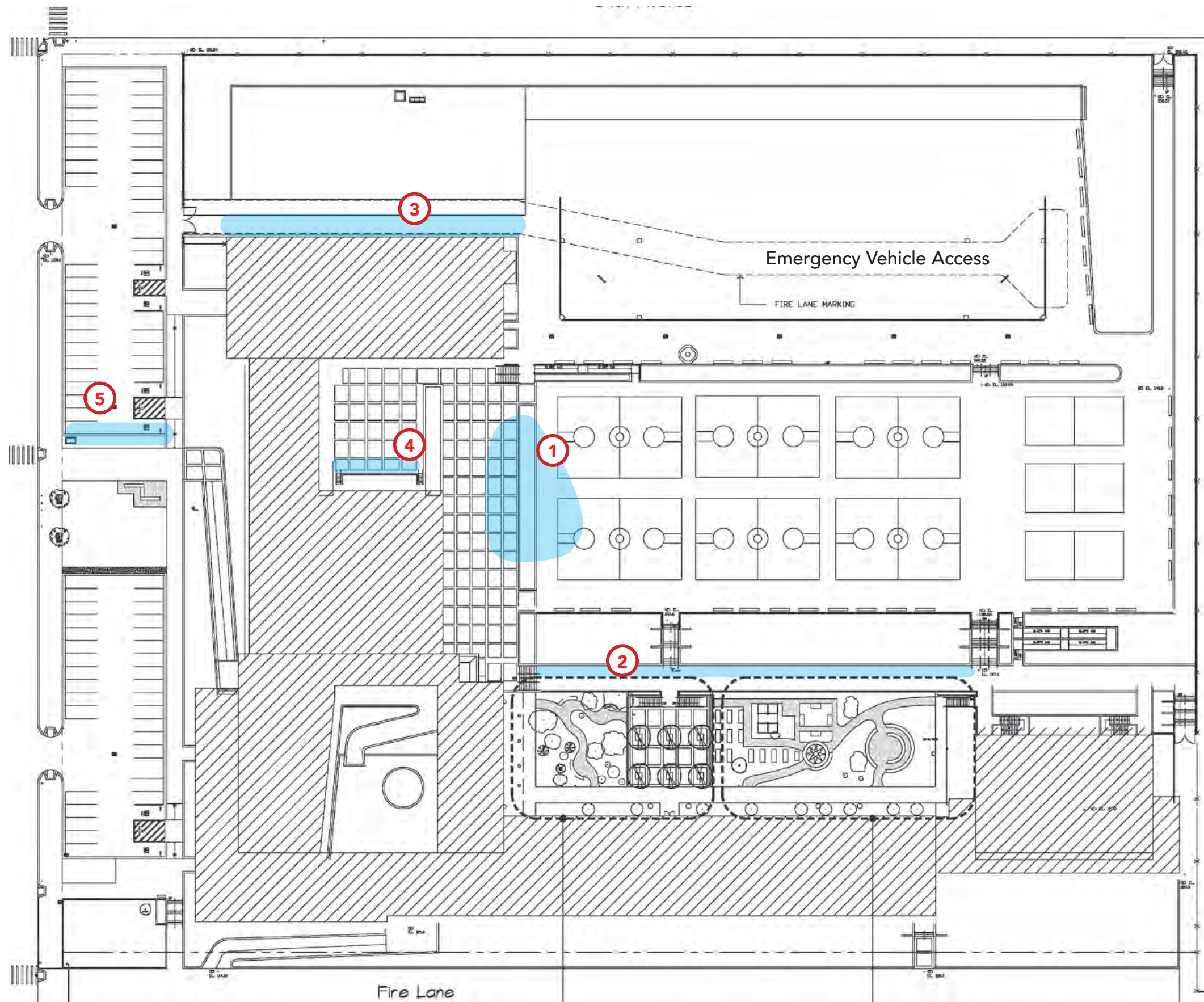

Localized Flooding

